

STANDARD FLEXPOST™ ANCHORING INSTRUCTIONS FOR ADHESIVE

Tools Required:

- Marker
- Gloves
- Standard Caulk Gun
- Rag

Parts Included:

- 1 Base Plate
- 1 MasterWeld 948

NOTE: THIS PRODUCT IS NOT INTENDED TO BE USED ON ASPHALT

WARNING: MUST ANCHOR UNIT ON THE SAME LEVEL AS THE PARKING LOT FOR PROPER FUNCTIONALITY

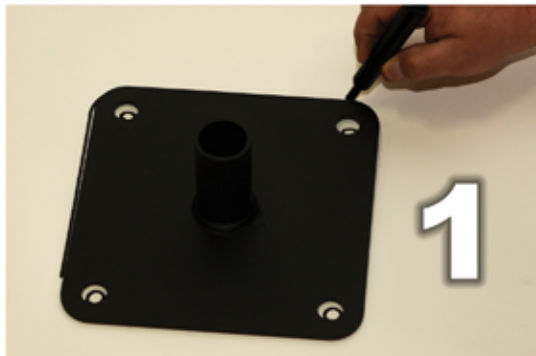

- Ensure that the application area is free of dirt, grease, oil, and moisture.
- Place the base in desired location and use a wax pencil or marker to outline the exterior of the base.



- Using the MasterWeld 948, glue the area within the outline.

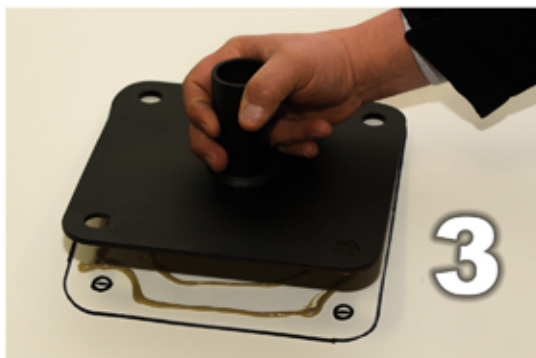

- Place the base on the adhesive within the drawn lines.



- Adhesive will come out the sides. Use a rag to wipe excess. Wait 24 hours for adhesive to be fully cured.

**FLEX
POST®**

2236 112th Ave, Suite 80
Holland, MI 49424
616-928-0829 • www.FlexpostInc.com